



Fare collection for
all coins and any bus

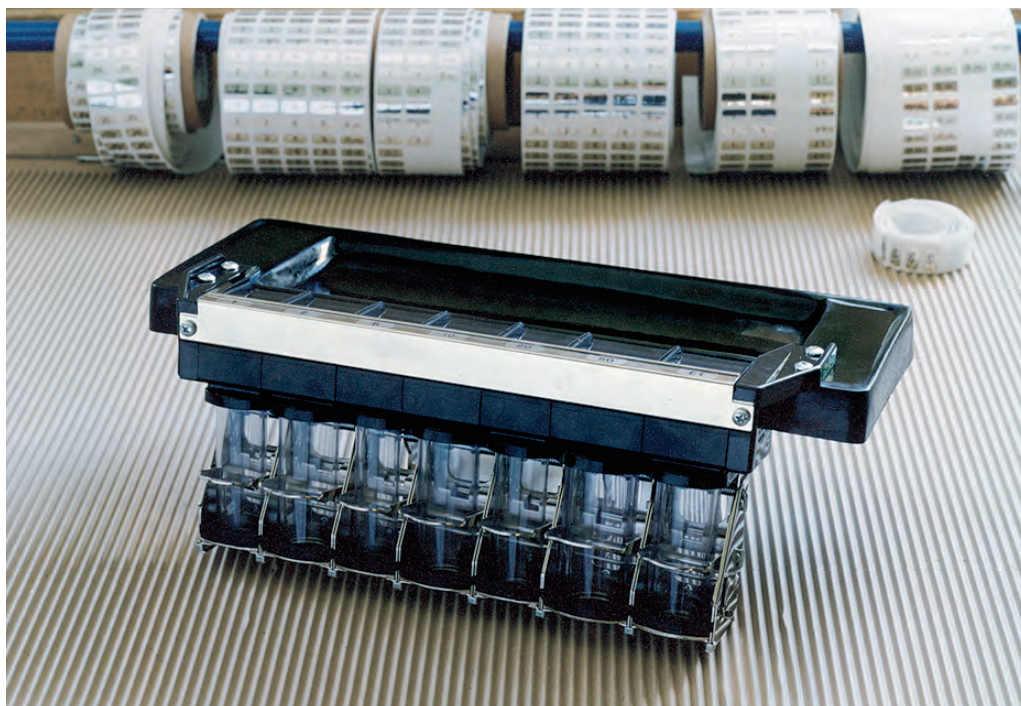

Table 98135 with coin guide and a seven tube dispenser (above). Coin-adjusted parts (to the right, top). The dispenser can be made for all kinds of coins. Four tube standard high dispenser, seven tube extra high dispenser and an exchangeable coin unit (to the right, bottom).

Fast and safe coin handling in public transport

The Cambist Coin Dispenser is an efficient and easy to use coin handling system on board your bus or tram. You simply sort the received coins into their tubes and with a light tap on the trigger you issue correct change. The parts are manufactured in tools adjusted to coin thickness and diameter, to secure a dependable and flawless function year after year. The dispenser is lockable to ensure safe storage of your cash.

Available in any combination

The dispenser can be built with up to seven coin tubes in any combination. The standard dispenser is equipped with 7 cm tubes and coin ejectors issuing one coin at a time and is supplied with mounting plates for coin tables and hooks for a

conductor's bag. It can also be built with 10,5 cm tubes, which allows more coins per tube.

New coins – no problem

In the event of a coin reform the dispenser can easily be rebuilt to meet new demands. We supply the essential coin units or parts and specified instructions for rebuilding.

Part of a fare collection system

Regardless of coin tube combination the dispenser can be fitted to any model of our coin tables. Applied to a conductor's bag, the coin dispenser becomes a mobile fare collection system and is easily brought along when leaving the vehicle.

Bags and more

A number of drivers' bags, purses and accessories are also available from Cambist. For detailed information please visit www.cambist.se

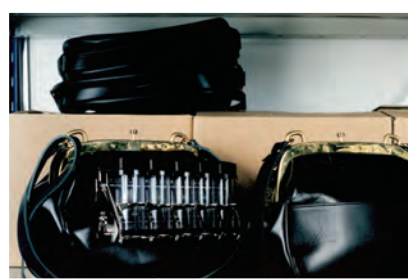

Conductor's bag, No. 303

Made of black leather with a frame and strap holders made of brass. Adjustable shoulder strap. Inside compartment for tickets and bank-notes. Outside pocket and strap for coin change dispenser. Size 300x200 mm.



Ticket punches

Made of nickel-plated steel and available with depths of 35 mm or 10 mm with a 3 mm round clip or individual clip symbol.

No. 310 (right) – Depth of jaw 35 mm. 310/1 Round. 310/2 Symbol. **No. 314 (left)** – Depth of jaw 10 mm 314/1 Round. 314/2 Symbol.

Easy fare collection and change giving on board

Our coin tables enable fast and easy fare collection and change giving. With ergonomics in mind we develop tables that fit not only the bus but also the driver. In combination with flexible mounting solutions they can easily be installed in most bus models.

Current models

The Cambist coin tables are available in a variety of versions as indicated below and many of them are designed to accommodate a ticket machine. All tables are sold with a coin guide for fast and easy sorting of coins into the correct coin tubes, and can readily accept the Cambist coin change dispenser. If requested, a table can also be supplied with a holder or hooks for a conductor's bag.

Mounting

The table can be supplied with an attachment stand or brackets for instalment on a dashboard or driver's partition. Other mounting solutions can be offered upon request.



Other sizes of tables than those listed can be custom made on request. All tables are available for left and right hand drive vehicles.

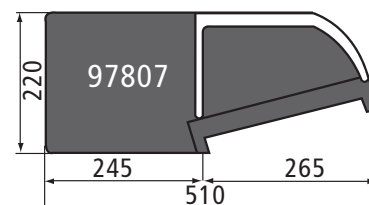
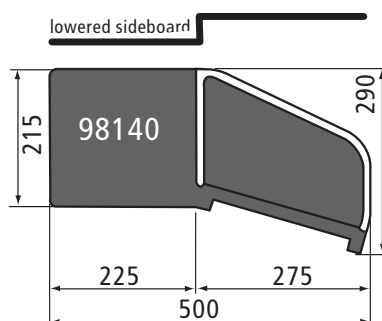
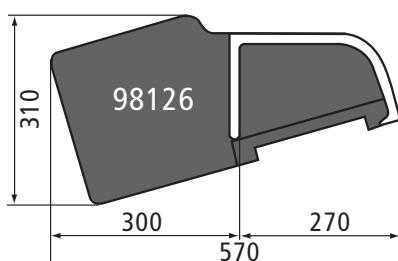
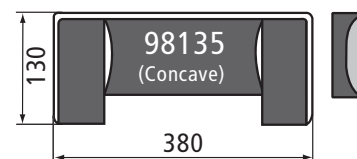
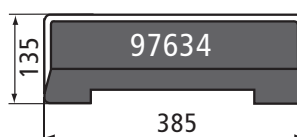
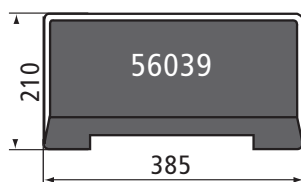
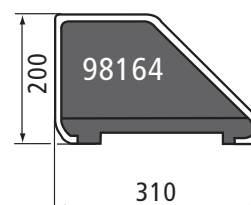
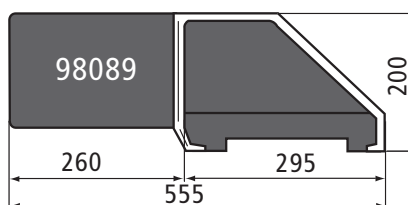
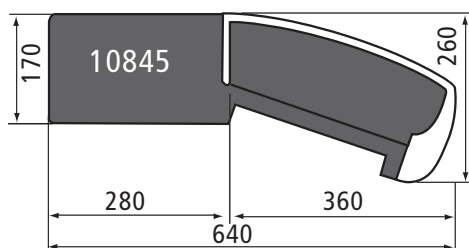
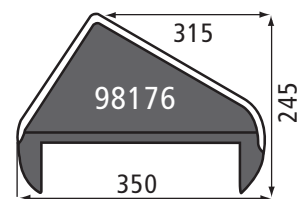
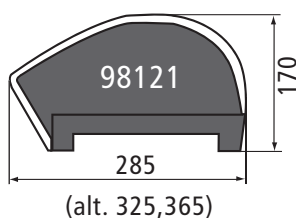

Spare parts for Cambist Coin Tables and Coin Guides

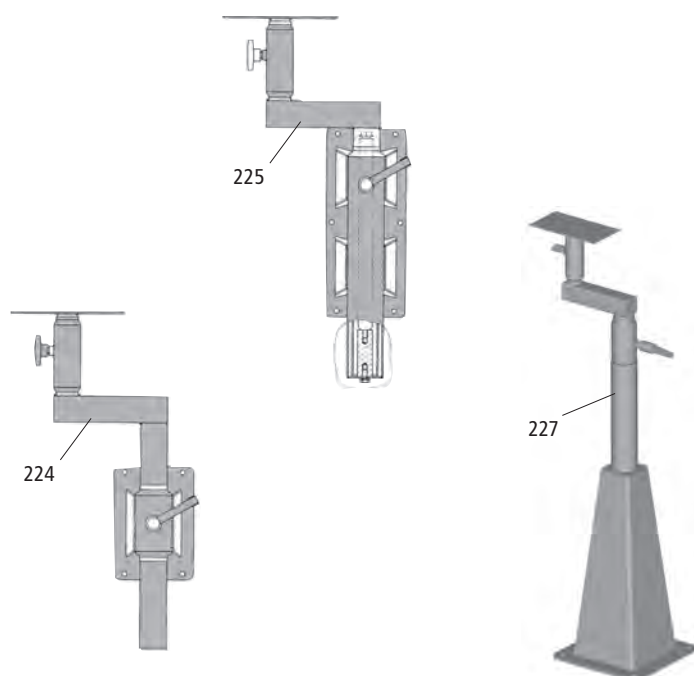
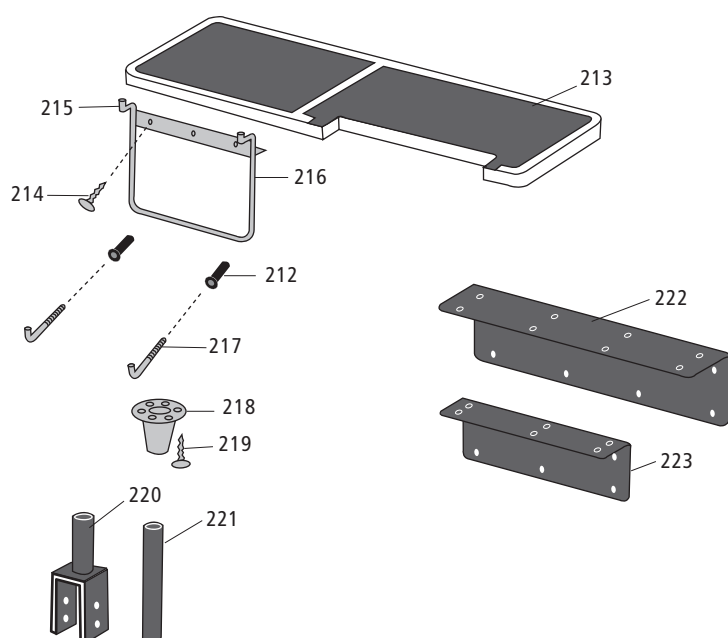
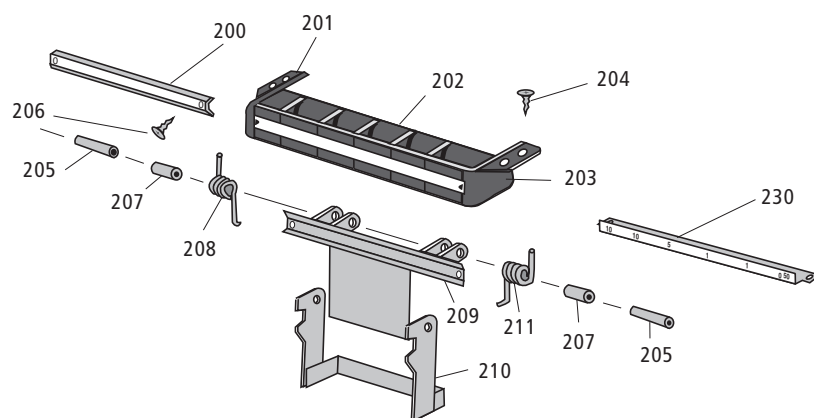

The coin table is made of fibreglass-reinforced plastic on a supporting frame and is supplied with a coin guide with a denomination bar. The coin guide consists of modules of ABS-plastic designed to fit the upper tube holders on the coin dispenser and a support plate with a release lever in nickel-plated steel, which makes it possible to fix the coin dispenser and easily release it from the coin table. Spare parts are available for immediate delivery from stock.

Spare parts for Coin Tables and Coin Guides

200	Supporting bar ¹⁾
201	Side piece, L/H
202	Tube module ¹⁾
203	Side piece, R/H
204	Screw
205	Spring guide pin
206	Screw
207	Spacer bush
208	Spring R/H
209	Supporting plate ¹⁾
210	Release lever ²⁾ (112 mm, 127 mm or 147 mm)
211	Spring, R/H
212	Rawlnut M5
213	Coin table
214	Bag holder screw
215	Bag holder, for table
216	Bag holder, for wall
217	Hooks for bag
218	Tube fitting
219	Tube fitting screw
220	Forked leg, 325 mm, ø 28 mm
221	Mounting shaft, 300 mm, ø 28 mm
222	Bracket, 80 x 100 x 350 mm
223	Bracket, 60 x 80 x 200 mm
224	Attachment stand for wall, 257–447 mm. Small plate (150 x 80 mm) or large plate (200 x 125 mm) for table ³⁾
225	Attachment stand with gas spring, 482–682 mm. Small plate (150 x 80 mm) or large plate (200 x 125 mm) for table ³⁾
227	Attachment stand for floor, 843–1023 mm, combined with Small plate (150 x 80 mm) or large plate (200 x 125 mm) for table ³⁾
230	Denomination bar ¹⁾

When ordering, please state:

- 1) Coin denominations
- 2) Length
- 3) Size

Spare parts for Cambist Coin Dispensers

The dispenser's parts are made out of nickel-plated steel, ABS plastic and transparent CAB plastic. Spare parts are available for immediate delivery from stock.

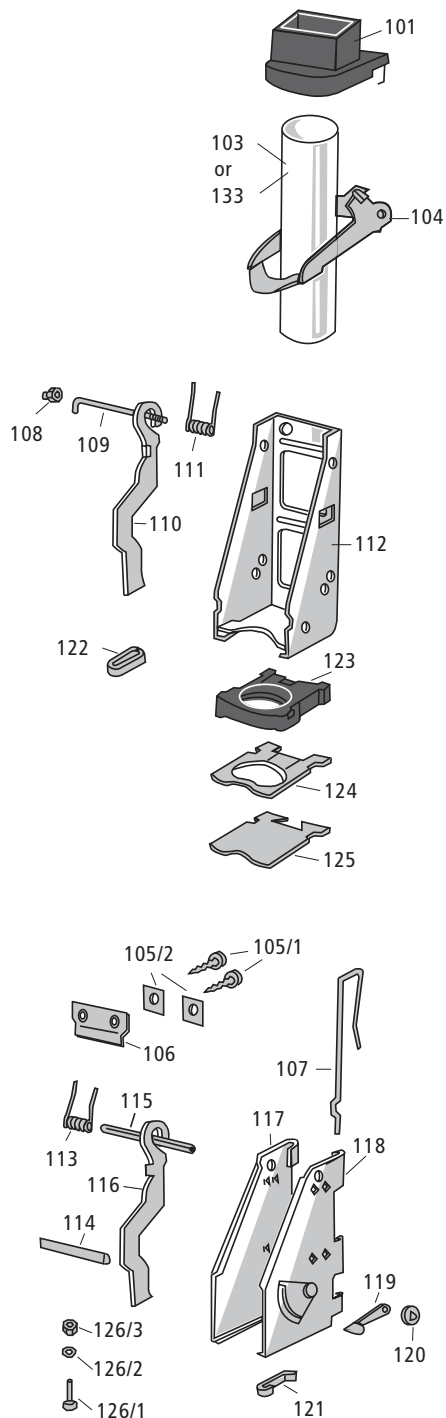

Special parts

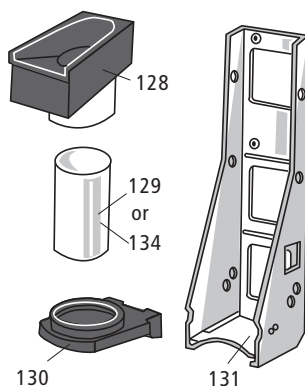

Spare parts for Cambist Coin Dispensers

101	Upper tube holder ¹⁾
102	Tube ring, al. tube ¹⁾ (not illustrated)
103	Plastic tube, standard height ¹⁾
104	Trigger ¹⁾
105/1	Screw for upper tube holder
105/2	Washer for upper tube holder
106	Mounting plate
107	Mounting hook
108	Hexagon nut
109	Shaft ²⁾
110	Ejector arm, L/H
111	Spring for ejector, L/H
112	Frame ¹⁾
113	Spring for ejector, R/H
114	Locking bar ²⁾
115	Bearing tube ¹⁾
116	Ejector arm, R/H
117	Side plate, L/H
118	Side plate, R/H
119	Locking lever
120	Centering washer
121	U clamp 1/2
122	U clamp 1/1
123	Lower tube holder ¹⁾
124	Ejector plate ¹⁾
125	Bottom plate ¹⁾
126/1	Screw for lower tube holder
126/2	Washer 47007 for lower tube holder
126/3	Nut for lower tube holder
128	Upper tube holder, special ¹⁾
129	Plastic tube, short ¹⁾
130	Middle piece ¹⁾
131	Frame, height 10,5 cm ¹⁾
133	Tube, aluminium, standard height ¹⁾
134	Tube, aluminium, short ¹⁾

When ordering, please state:

- 1) coin denomination
- 2) length



Assembly of a 7-unit dispenser.



Testing of a gas spring attachment stand

Flexible products – flexible production

Since 1969 Cambist AB has developed coin handling products for fare collection in public transport. Our motto has always been flexibility, both when it comes to satisfying customer needs and the manufacturing of our products. Together with technical engineers we develop our products which are then produced in Cambist's tools and moulds, by subcontractors throughout Sweden. Our offices, development and assembly units are located in Norrtälje, 60 kilometres north east of Stockholm, Sweden.

The Cambist fare collection system is in use in over 200.000 buses around the world. In Sweden we serve our customers directly while sales and marketing abroad are taken care of by agents with interests in the public transport market in their country.

Agent:



Cambist AB, Box 204, SE-761 23 Norrtälje, Sweden
 Telephone: +46 176 172 45, Fax: +46 176 139 51
 E-mail: info@cambist.se, Web: www.cambist.se